

Installation Instructions for 920 Series Leverset

for dummy applications for new doors

Step 1.

- Fold template where indicated.
 - Position template on door edge at desired height.
 - Firmly hold template and mark centre points of handle fixing holes on door face at required backset (refer template).
 - Drill two 10mm (3/8") holes right through the door at required backset and one 35mm (1 3/8") hole to a recess of 6mm.
- Ensure 10mm holes are drilled first.**

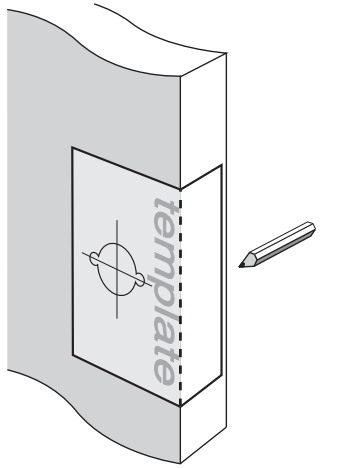

Step 2.

- Insert blind screws and brass posts to the lever/escutcheon assembly.

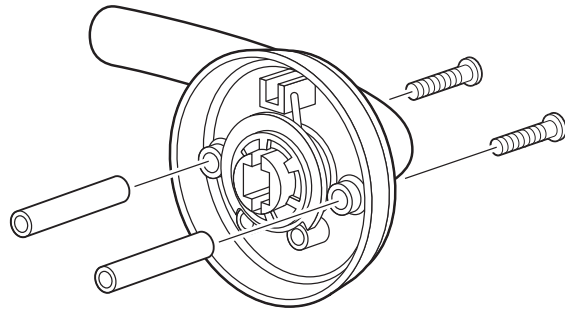

Step 3.

- Fasten lever/escutcheon assembly and circular plate together with screws provided.

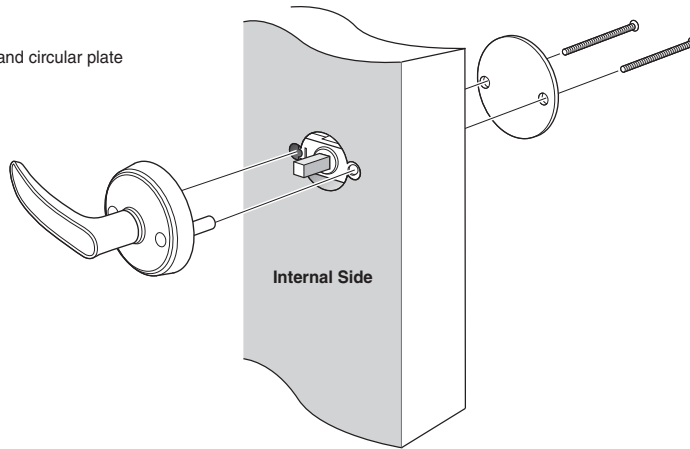

Note: Ensure screws are located on the internal side of the door.

NOTE: Carefully follow these instructions when installing. Screws to be tightened to a recommended 2.5Nm torque.



FOLD HERE

Fit here on door edge

10mm (3/8") hole
(drill first, right through door)

19-35mm hole
recess 6mm deep
(drill second)

BACKSET 60mm (2 3/8")

BACKSET 70mm (2 3/4")

Fit here on door edge

10mm (3/8") hole
(drill first, right through door)

Gainsborough[®]

Gainsborough Hardware Industries Limited,
Melbourne, Australia. A.B.N. 25 004 792 269
www.gainsboroughhardware.com.au

Installation template
for dummy applications