

**ADJUSTABLE LATCH WHERE APPLICABLE**  
 To change backset from 60mm (2<sup>3</sup>/<sub>8</sub>" ) to 70mm (2<sup>3</sup>/<sub>4</sub>" ), pull spindle cam in the direction away from faceplate. To reset to 60mm (2<sup>3</sup>/<sub>8</sub>" ) backset, push spindle cam back to original position (towards faceplate).

**FITTING TO MORTICE LOCKS**  
 Discard posts and screws, after locating fixing plates drill 3 holes x 4mm (5/32") diam. into each side of door and fix with 10 gauge x 3/8" self tapping screws.

**INSTALLATION INSTRUCTIONS FOR GAINSBOROUGH DUAL SPRUNG TUBULAR LATCH SYSTEM**

- Scribe drilling centres using appropriate template (see over).
- Drill door as shown at Fig. 1/1A and fit latch.
- Unscrew fixing plates from knob assemblies (see Fig. 1B).
- Insert short screws through 2 small holes and attach the 2 posts to underside of one fixing plate.
- Insert posts through door and latch and fasten 2nd plate with 2 long screws.
- Insert drive shaft through the latch and screw the door knob assemblies to fixing plates until roses make firm contact with door.

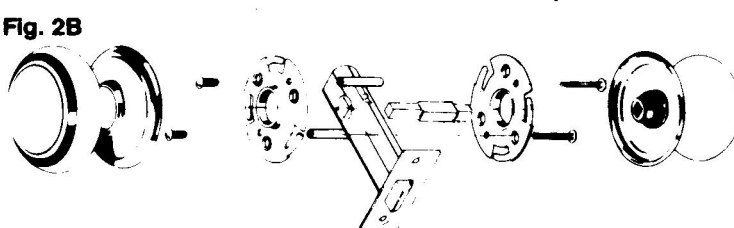
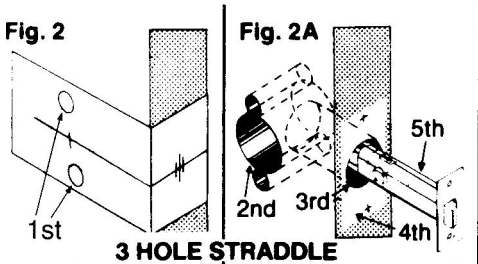

**INSTALLATION INSTRUCTIONS FOR STRADDLE TUBULAR LATCH SYSTEM**

- Scribe drilling centres using appropriate template (see over).
- Drill door as shown at Fig. 2/2A and fit latch.
- Unscrew fixing plates from knob assemblies (see Fig. 2B).
- Insert short screws through 2 small holes and attach the 2 posts to underside of one fixing plate.
- Insert posts through door to straddle latch, fit 2nd plate, ensure central fitting, secure with long screws.
- Insert drive shaft through the latch and screw the door knob assemblies to fixing plates until roses make firm contact with door.



Gainsborough Hardware Industries Limited, ACN 004 792 269, ABN 25 004 792 269, 190 Whitehorse Road, Blackburn, Victoria, 3130

PAIT 052

**INSTALLATION INSTRUCTIONS FOR GAINSBOROUGH DUAL SPRUNG OR STRADDLE TUBULAR LATCH SYSTEM**

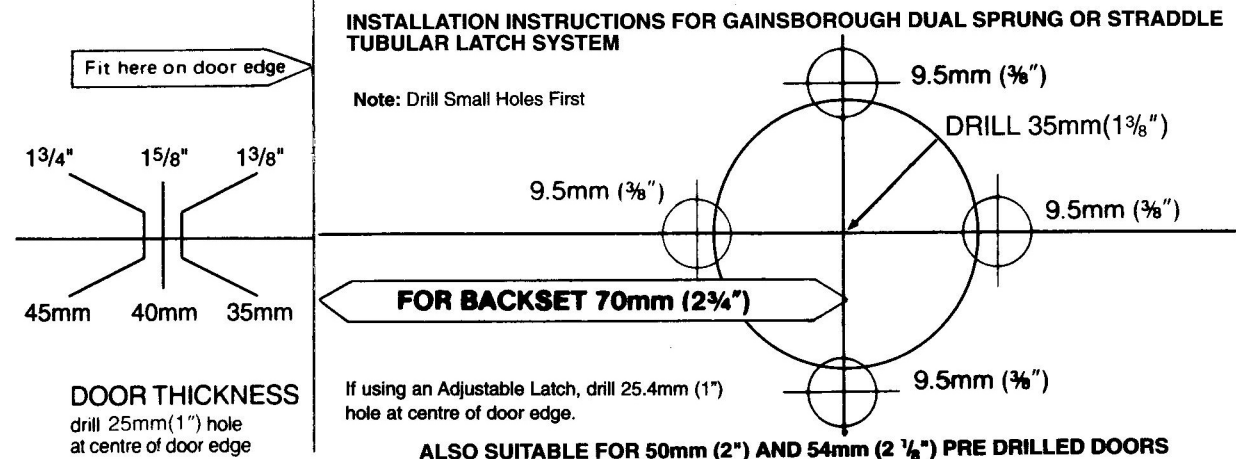
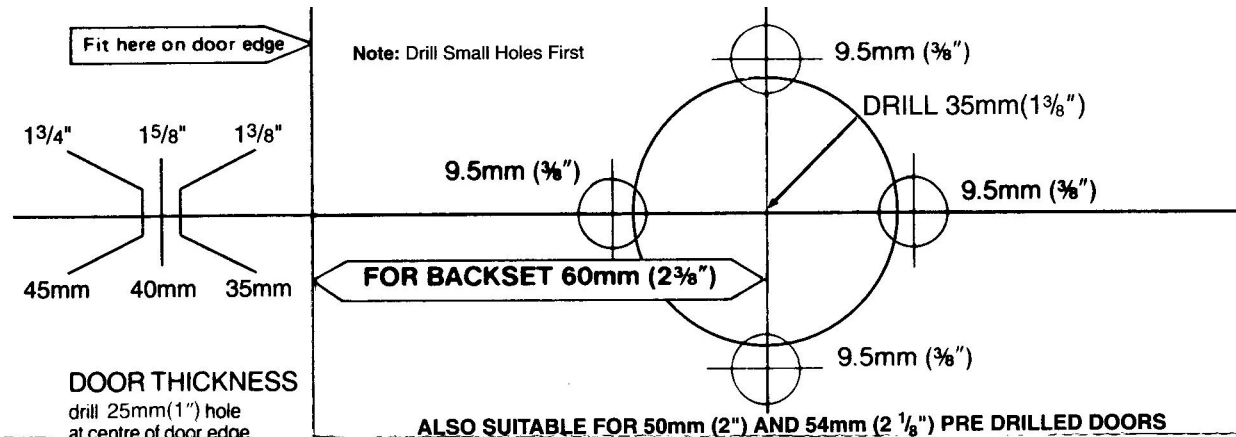

## Privacy Adaptor Fitting Instructions Enclosed

Installation procedure for privacy adaptor which suits Gainsborough fashion knobsets when used in conjunction with Gainsborough self-aligning latches for internal doors 33mm – 40mm (1¼" – 1⅝") in thickness.

For thicker doors up to 50mm (2") you will require an extended screw and spindle kit (KT137).

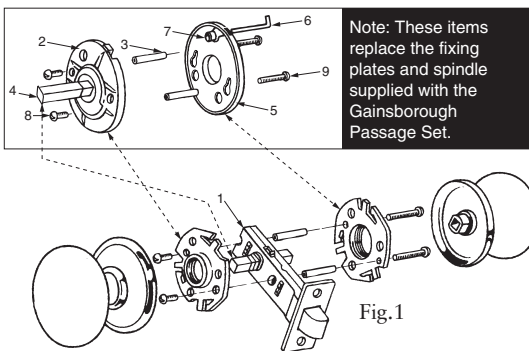

Note: These items replace the fixing plates and spindle supplied with the Gainsborough Passage Set.

Fig.1

Fig. 1

1. Self-aligning latch
2. Inside assembly (snib side)
3. Brass posts (supplied with knobset)
4. Spindle
5. Outside assembly (emergency release side)
6. Emergency release bar
7. Emergency release bar hole
8. Short Screws
9. Long Screws

Manufactured by  
Gainsborough Hardware Industries Limited  
Melbourne, Australia  
[www.gainsboroughhardware.com](http://www.gainsboroughhardware.com)

*Gainsborough*<sup>®</sup>  
fine quality door hardware



# privacy adaptor kit

SUITS GAINSBOROUGH PRODUCT ONLY

This kit adds  
privacy locking function  
to all Gainsborough  
door knob sets



- Positive snib locking.
- Panic release from inside.
- Emergency access from outside.
- Tarnish resistant finish.
- Simple installation.

**MADE IN AUSTRALIA**

## Privacy Adaptor Fitting Instructions

**Note:** All numbers in brackets ( ) denote an item in Fig. 1 on back cover.

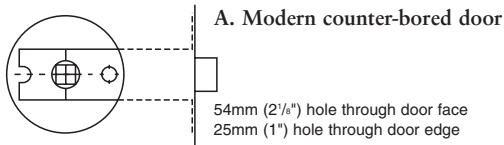

1. For older doors (B) drill additional 8mm hole as shown in red from 'inside' door face (snib side), after which installation is identical for A. & B. doors.

2. Fit Gainsborough 'self-aligning' latch (1).
3. Insert two short screws (8) through 'inside assembly' (2) and firmly attach 'brass posts' (3).

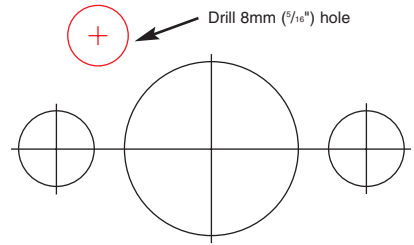
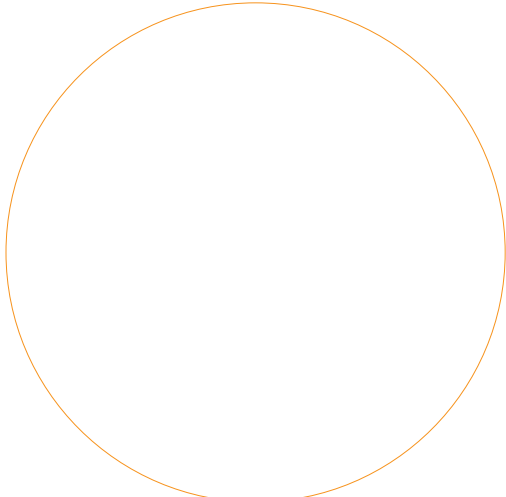
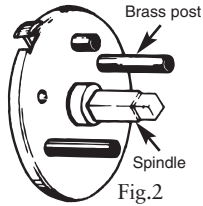

Place template on inside door face (snib side).

### B. Older door with 23mm middle hole.

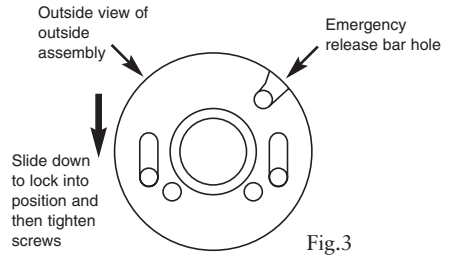

4. Locate spindle into square hole in 'inside assembly' and insert 'brass posts' (3) and 'spindle' (4) through latch until assembly makes firm contact with door face. See Fig. 2.
5. Insert long screws (9) into 'brass posts' for a few turns.
6. Ensure that 'emergency release bar hole' (7) is facing upwards and slip the keyholes in the 'outside assembly' (5) over the protruding screw heads and slide downwards. See Fig. 3.
7. View assemblies from edge of door and adjust for level. Tighten screws firmly in keyhole slot.
8. Insert 'L' shaped 'emergency release bar' (6) into 'outside assembly emergency release bar hole'. See Fig. 1.

**Note:** Please ensure your doorstops have adequate clearance to prevent damage to your knobset or wall.

