

Installation Instructions for 9600PH Series Architectural Pull Handle Entrance Set

Congratulations on the purchase of your new Gainsborough 9600PH Architectural Pull Handle Entrance Set. Use this instruction sheet in conjunction with template provided. Full details included on door preparation and the installation steps required for installing all door hardware.

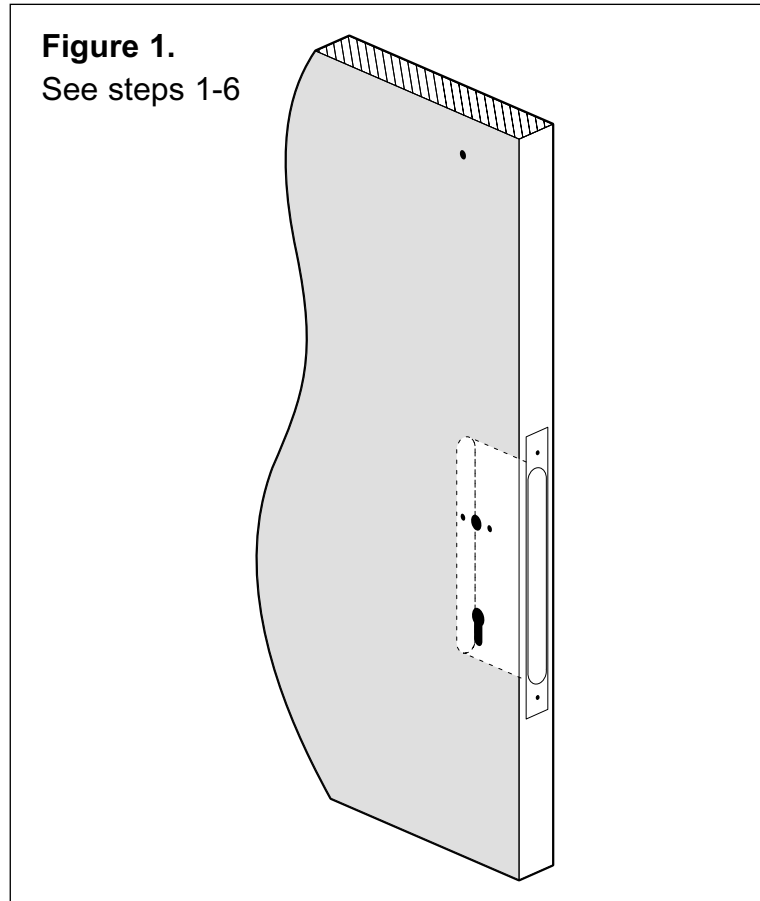

Figure 1.
See steps 1-6

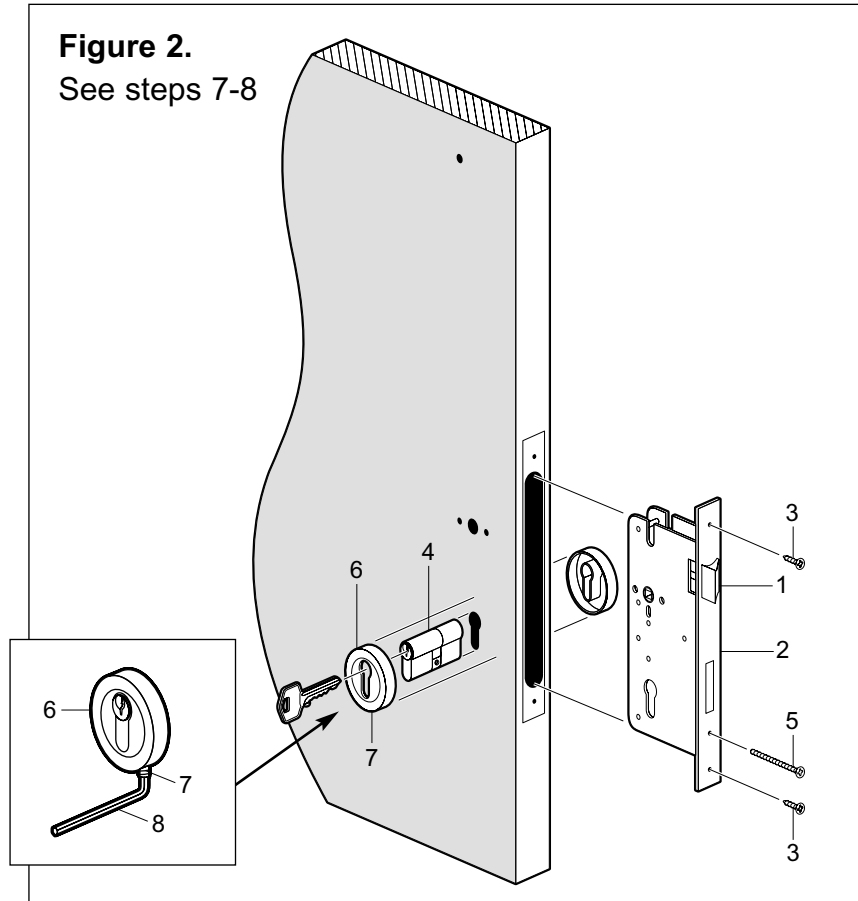

Figure 2.
See steps 7-8

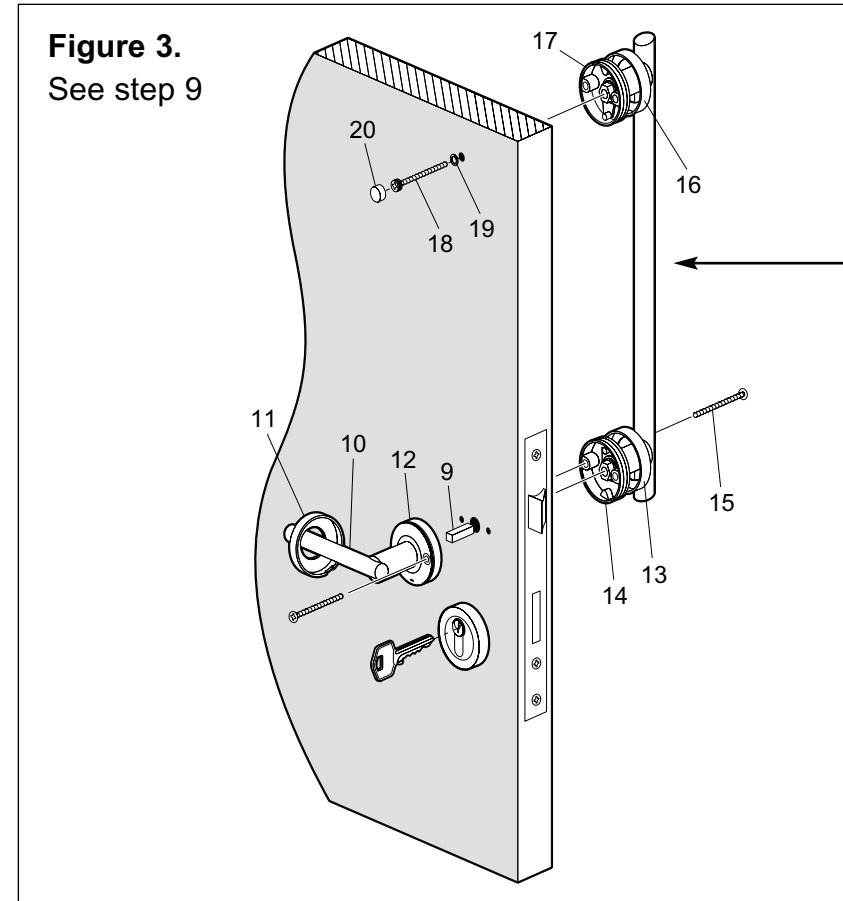
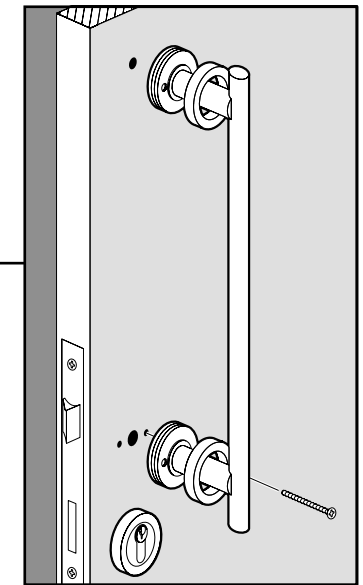

Figure 3.
See step 9



Inset: View of external handle from exterior

AT 035

Mark location of drill holes using template provided (see Figure 1.)

Use template to determine the preferred position for the Pull Handle Entrance Set on the door:

Step 1. Mark location of mortice lock holes by using the door edge section template

✘ Measure door thickness and mark a vertical centre line on door edge at desired height.

✘ Line up the door edge template with this line and mark the series of 19mm dia. holes required for mortice lock body in door edge.

Step 2. Mark location of holes through the door face by using both door face sections of template for both sides of door

✘ Fold template where indicated on door edge (ensure template lines up with door edge markings referred to in step 1).

✘ Use template to mark 17.5mm dia. hole and 10.5mm dia. hole for cylinder on both sides of the door.

✘ Use template to mark 22mm dia. spindle hole, the two only 6mm dia. door fixing holes for screws (on either side of spindle hole); and the 6mm dia. screw hole for top of pull handle. All to be marked on both sides of the door.

Mortice door edge and drill holes through door face (see Figure 1.)

Step 3. Mortice door edge for mortice lock body

✘ Drill the series of 19mm dia. holes as marked in step 1 above. Drill to a depth to suit the lock body (mark drill bit with a piece of tape to indicate the correct drill depth- use lock body or template as a guide to set the tape).

✘ Remove and clear out remaining timber with a sharp chisel.

Step 4. Mark and chisel out rebate in door edge for mortice lock faceplate

✘ Insert mortice lock briefly into door rebate.

✘ Mark outline of faceplate with pencil then remove lock.

✘ Chisel out the above area with a sharp chisel to suit the depth of the faceplate.

✘ Re-insert lock briefly (or use template) to mark small diameter pilot holes for faceplate installation (top and bottom).

Step 5. Drill the cylinder holes through door face

✘ Drill 17.5mm dia. hole and 10.5mm dia. hole as marked in step 2, for cylinder, ensuring holes are drilled from both sides of the door. Then chisel out timber in between these holes to create an elongated hole for cylinder.

Step 6. Drill the door face holes for furniture spindle and fixing holes

✘ Drill 22mm dia. hole for spindle; the two 6mm dia holes for fixing screws and top 6mm dia. hole for pull handle.

Note: All holes are as marked in step 2, and should be drilled from both sides of door.

Install mortice lock and cylinder escutcheons (see Figure 2.)

Step 7. Drill the cylinder holes through door face

✘ Ensure bevel of latchbolt (1) is facing direction of door closure.

If this needs to be altered, insert and press flat-headed screw driver behind latchbolt and rotate latchbolt 180 degrees.

✘ Fit mortice lock (2) with screws (3) provided into door edge.

Step 8. Install cylinder and escutcheons

✘ Insert cylinder (4) through door face into hole.

✘ To affix cylinder in place, insert cylinder retaining screw (5) through hole in faceplate and tighten into cylinder.

✘ Position cylinder escutcheons (6) over each end of the cylinder. Push each escutcheon up against door, ensuring grub screw (7) is on the underside. Tighten grub screws with the allen key (8) provided.

Install external pull handle and inside lever (see Figure 3.)

Step 9. Install external handle and inside lever

Install bottom of handle with the inside lever:

✘ Insert square drive spindle (9) through mortice lock in door, choosing shorter spindle for doors 32mm-40mm thick and the longer spindle for doors 40mm-45mm thick.

✘ Then choose lever and rosette assembly (10) required for the inside of the door, ensuring the lever chosen will move in a downward position once installed.

Put the other lever aside as this will not be required.

✘ Remove rosette cover (11) from the chosen lever assembly under-rose (12). Also unscrew rosette cover (13) from bottom pull handle under-rose (14).

✘ Fasten lever assembly under-rose (12) with the bottom pull handle under-rose (14) with screws provided (15).

Use long screws for thick doors and short screws for thin doors. Each under-rose features a countersunk hole and threaded hole. Install one screw from either side, through the countersunk hole, through the lock and into the threaded hole on the opposite under-rose.

✘ Then loosely tighten the screw head on each side at this stage.

Install top of pull handle to door:

✘ Unscrew the rosette cover (16) from the top pull handle under-rose (17).

✘ Ensure top pull handle under-rose (17) is positioned over drilled hole in door face.

✘ Insert mounting screw (18) through washer (19) through drilled hole in door and into threaded hole in centre of top of pull handle under-rose (17).

✘ Tighten screw head-do not over tighten.

✘ Place cover cap (20) over mounting screw washer.

✘ Screw on rosette cover (16) to top pull handle under-rose (17).

Then tighten screws connecting bottom of pull handle with inside lever — do not over tighten. Reapply rosette covers as follows:

✘ Reapply rosette cover to each under-rose by pushing the rosette cover (11) over the rubber ring on the lever assembly under-rose (12) until flush with door; and by screwing the rosette cover (13) over the bottom pull handle under-rose (14) until flush with door.

Install strike plate in door jamb

Step 10. Mortice out and install strike plate

✘ Extend deadbolt with key.

✘ Close door and mark location of both latchbolt and deadbolt on the door jamb.

✘ Extend these lines across jamb and mark the centre position of where both latchbolt and deadbolt would locate in jamb on door closure.

✘ Centre strike plate over holes and mark outline of strike plate and the two rectangular cut-out areas for bolts.

✘ Drill a series of holes and mortice rectangular cut-outs to accommodate the latchbolt and deadbolt. Drill above holes to required depth into door frame to accommodate latchbolt and deadbolt (when fully extended into door frame).

✘ Chisel out recess in door jamb for faceplate to sit flush with door jamb.

✘ Drill two only pilot holes and install with screws supplied.

Features easy operation

✘ Turning key in outside or inside cylinder will lock deadbolt. Additional turn of the key will double throw the deadbolt for added security.

✘ Retract deadbolt by turning key in opposite direction. Full rotation of the key will also retract latchbolt for one-handed access.

✘ Therefore, when deadbolt is disengaged — key is required to enter by retracting latchbolt. Exit by turning the inside lever to retract latchbolt.

Gainsborough recommends that deadbolt remains unlocked whilst inside the home. If deciding to lock the deadbolt whilst inside the home, it is suggested that the key be left in the inside cylinder for easy exit.