



Finishes

SS Stainless Steel

PB Polished Stainless Steel

PS Polished Brass

Latchbolt

14mm Sintered Stainless Steel.

Backsets Available

60mm.

A passage latch for matching case dimensions of the 3000 series mortice lock.

No locking capability but with heavy duty spring.

Limiting Dimensions

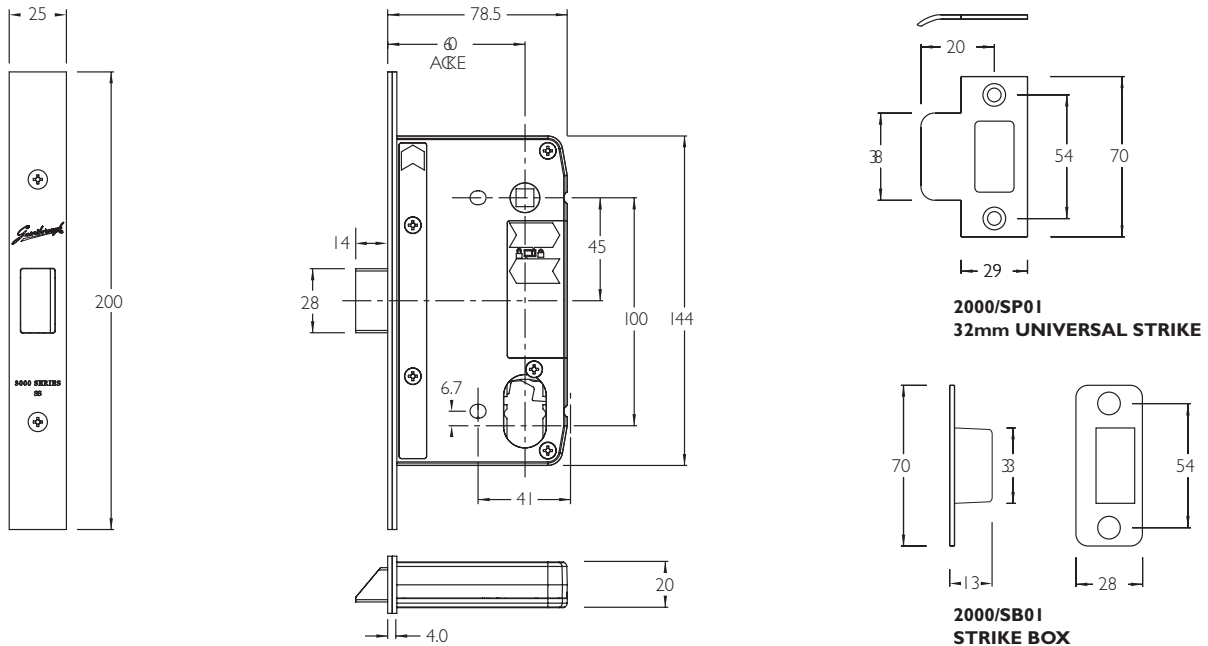

3600 Series Passage Latch

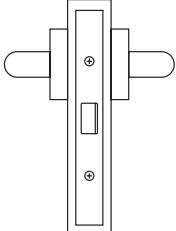
PRODUCT	DESCRIPTION	CATALOGUE NO.
<p>Passage Set</p> 	<p>Non Locking. Latchbolt operated by handles either side at all times.</p>	<p>3600</p>

Finish Codes: **PB** Polished Brass **PS** Polished Stainless Steel **SS** Stainless Steel

Note: Add finish code to above to form complete catalogue number e.g. 3600 SS