



Combination locks are operated by handles from inside or outside. Both handles are locked or unlocked by a series of cylinders and/or turnbuttons. Latch is deadlatched by auxiliary bolt on closure of door.

### Finishes

- CP** Chrome Plate
- SC** Satin Chrome Plate
- PB** Polished Brass

When ordering, add relevant finish code to form complete catalogue number.

List escutcheons and turnbuttons separately – Refer to page 3.15, 3.25 and 3.30.

### Latchbolt

14mm Standard Latchbolt (19mm).

### Backsets Available

60mm.

### Special Keying

Each locking function can be specially keyed in a Gainsborough 6 pin tumbler system to meet the needs of commercial or residential building requirements. Locks can be keyed alike, master keyed, grand master keyed, maison keyed and project keyed – Refer to page 1.5 for details.

### Limiting Dimensions

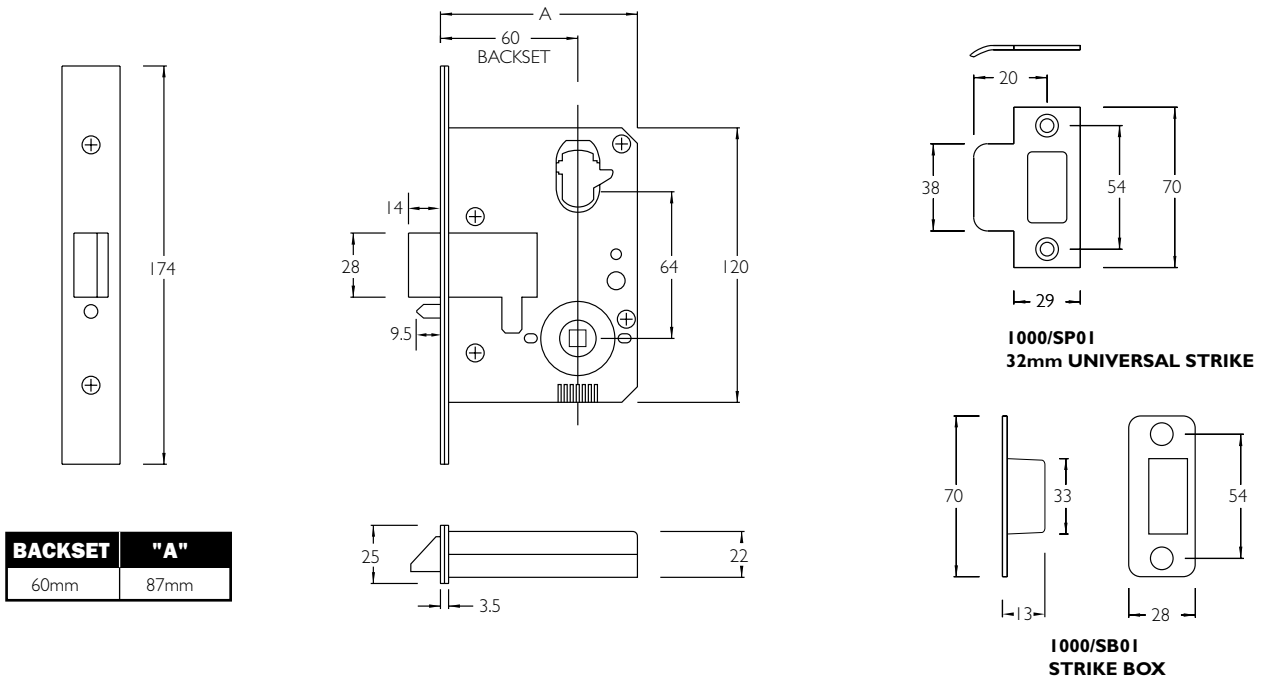

### 1500 Series Mortice Combination Locks

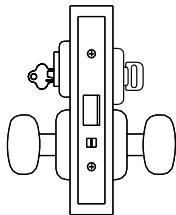
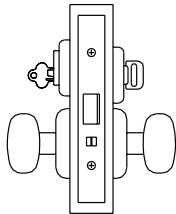
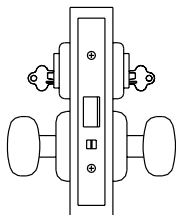
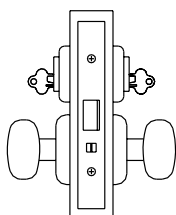
PRODUCT	DESCRIPTION	CATALOGUE NO.
<p><b>Entrance Door Lock</b></p> 	<p>Cylinder and Turnbutton.</p> <p>Latchbolt operated by handles either side. Both handles are locked or unlocked by either key from outside or turnbutton inside.</p> <p>Auxiliary bolt deadlatches when door is closed.</p>	<p><b>15JA</b></p>
<p><b>Entrance/Office Door Lock</b></p> 	<p>Cylinder and Turnbutton.</p> <p>Latchbolt operated by handles either side. Both handles are locked or unlocked by turnbutton inside. Key from outside retracts latch.</p> <p>Auxiliary bolt deadlatches when door is closed.</p>	<p><b>15CA</b></p>
<p><b>Glass Door Lock</b></p> 	<p>Double Cylinder.</p> <p>Latchbolt operated by handles either side. Both handles are locked or unlocked by key from either side.</p> <p>Auxiliary bolt deadlatches when door is closed.</p>	<p><b>15JJ</b></p>
<p><b>Glass Door Lock</b></p> 	<p>Double Cylinder.</p> <p>Latchbolt operated by handles either side. Both handles are locked or unlocked by key from inside. Key outside retracts latchbolt.</p> <p>Auxiliary bolt deadlatches when door is closed.</p>	<p><b>15CJ</b></p>

**Finish Codes:** **CP** Chrome Plate **SC** Satin Chrome Plate **PB** Polished Brass

**Note:** Add finish code to above to form complete catalogue number e.g. 15JA SC.

### 1500 Series Mortice Combination Locks

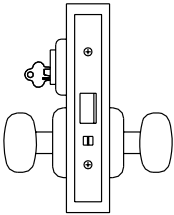
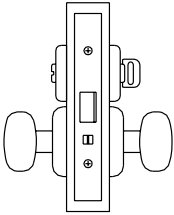
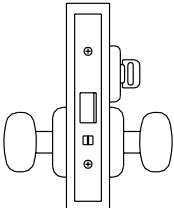
PRODUCT	DESCRIPTION	CATALOGUE NO.
<p><b>Entrance Door Lock</b></p> 	<p>Cylinder Outside.</p> <p>Latchbolt operated by handles either side. Both handles are locked or unlocked by key from outside.</p> <p>Auxiliary bolt deadlatches when door is closed.</p>	<b>15JO</b>
<p><b>Privacy Lock</b></p> <p>(With Kick-off if required)</p> 	<p>Emergency Release and Turnbutton.</p> <p>Latchbolt operated by handles either side. Both handles are locked or unlocked by turnbutton inside.</p> <p>Outside emergency release will unlock handles via a coin slot.</p> <p>Kick-off is available.</p>	<b>15EA</b>
<p><b>Patio Door Lock</b></p> 	<p>Turnbutton Inside.</p> <p>Latchbolt operated by handles either side. Both handles are locked or unlocked by turnbutton inside.</p> <p>Auxiliary bolt deadlatches when door is closed.</p>	<b>15OA</b>

**Finish Codes:** **CP** Chrome Plate **SC** Satin Chrome Plate **PB** Polished Brass

**Note:** Add finish code to above to form complete catalogue number e.g. 15JO SC.